

Route of Cathedrals in Northern Portugal



The **ROUTE of CATHEDRAL** project was established between the Portuguese State and the Catholic Church, in 2009.

The invaluable religious, cultural, symbolic, patrimonial, historic, and cultural value of the Portuguese Cathedrals is highlighted in the “Cooperation Agreement” signed by the proper authorities.

It is the mission of the ROUTE of CATHEDRALS project to achieve the empowerment of monuments, towards a cultural offer of excellence, in alliance with a careful cultural programming, involving the community in its protection and enhancement.

THERE ARE FOUR MAIN STRATEGIC AIMS FOR THE CATHEDRALS:

- 1) patrimonial recovery of the immovable and movable assets**
- 2) heritage interpretation and meaning of the places**
- 3) boosting the cultural offer in their spaces**
- 4) promotion of the Rota and each of its poles**

The Regional Directorates for Culture (and these with ecclesiastical institutions responsible for Cathedrals) have been proposed to implement the regional component of a nationwide project.

The Northern Portugal Regional Directorate for Culture planned a set of interventions for the architectural enhancement and the recovery of the mobile and integrated heritage: the **ROUTE of CATHEDRALS in the North**.

Considering the defined mission and aiming at the fulfillment of the strategic aims listed above, a set of actions was programmed to integrate an application to funding - ON.2 program - entitled: "Route of Cathedrals in Northern Portugal".

The Application 'Route of Cathedrals in Northern Portugal'



Operação "Rota das Catedrais no Norte de Portugal"

DIRECÇÃO REGIONAL
DA CULTURA DO NORTE



Julho 2011

Programa Operacional Regional do Norte 2007-2013

Convite Público para Apresentação de Candidaturas
"Rota das Catedrais" (VEETR-Rota das Catedrais/2011)

Eixo Prioritário II – Valorização Económica de Recursos Específicos
Valorização Económica da Excelência Turística Regional



Operação "Rota das Catedrais no Norte de Portugal"

DIRECÇÃO REGIONAL
DA CULTURA DO NORTE



Setembro 2013

Programa Operacional Regional do Norte 2007-2013

Convite Público para Apresentação de Candidaturas
"Rota das Catedrais" (VEETR-Rota das Catedrais/2011)

Eixo Prioritário II – Valorização Económica de Recursos Específicos
Valorização Económica da Excelência Turística Regional



é celebrado o presente **CONTRATO DE FINANCIAMENTO**, relativo à Operação com o Código NORTE-08-0169-FEDER-000160, designada por “Rota das Catedrais no Norte de Portugal”, cujo cofinanciamento FEDER, no âmbito do Eixo Prioritário 2, foi aprovado pela Comissão Diretiva do ON.2, em 16 de outubro de 2013. Este Contrato é outorgado de boa fé e reciprocamente aceite, regendo-se pela legislação e pela regulamentação nacionais e comunitárias aplicáveis e pelas disposições constantes das cláusulas seguintes.

Cláusula Primeira - *(Objeto e Natureza do Contrato)*

O presente Contrato tem por objeto a concessão de uma comparticipação financeira do FEDER, no âmbito do ON.2, destinada a financiar a Operação atrás identificada.

Cláusula Terceira - *(Custo da Operação e montante da comparticipação FEDER)*

1. De acordo com o disposto na decisão favorável de financiamento:

- a) O custo total da Operação é de 4.389.684,03 euros (quatro milhões, trezentos e oitenta e nove mil, seiscentos e oitenta e quatro euros e três centavos);
- b) O custo total elegível da Operação é de 4.149.338,86 euros (quatro milhões, cento e quarenta e nove mil, trezentos e trinta e oito euros e oitenta e seis centavos).

Commitments and execution (jun.2014)

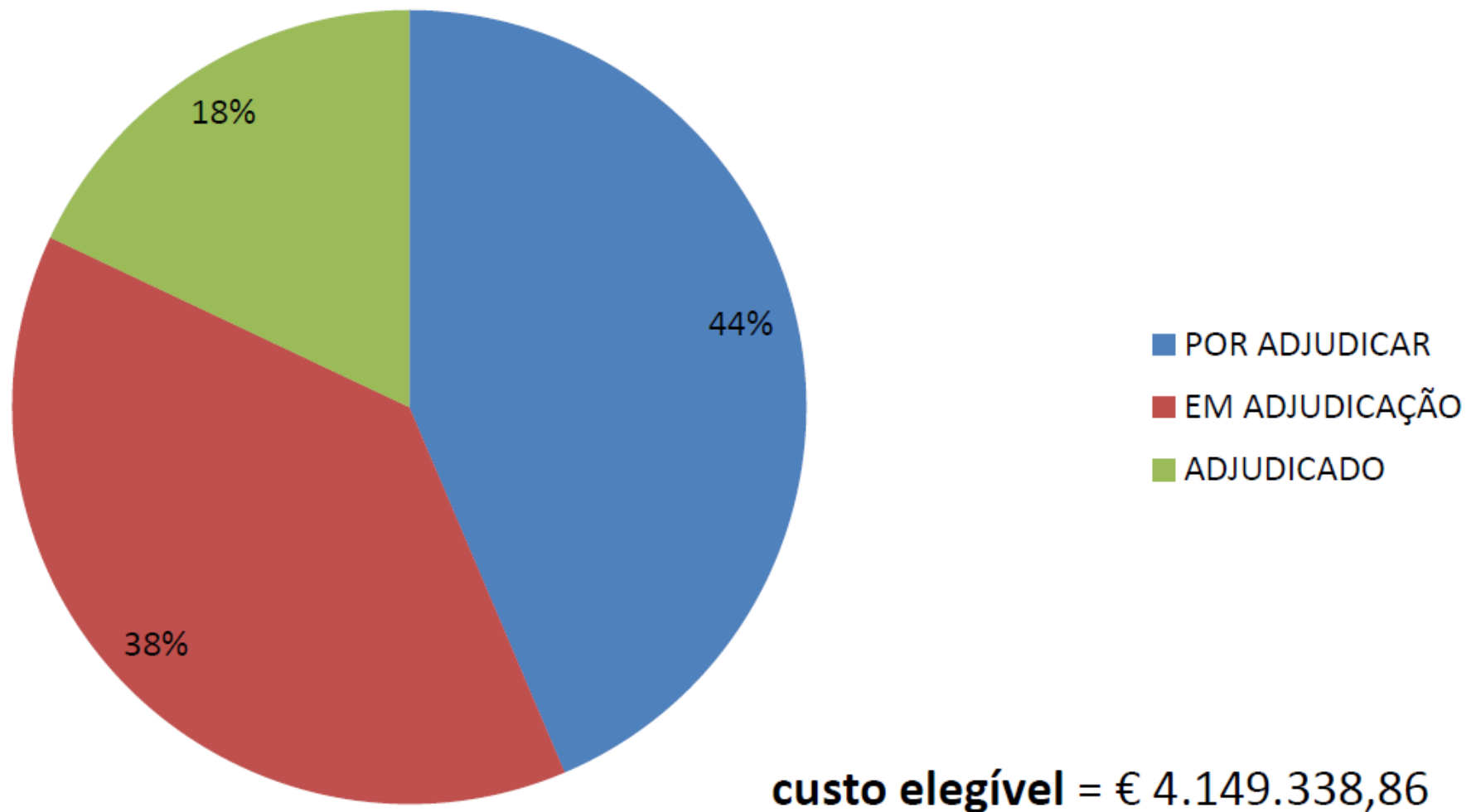

a destination for the Cathedrals in Northern Portugal

The "Route of Cathedrals in Northern Portugal" project should be understood as an opportunity to
*intervention or asset recovery and
dynamization and cultural dissemination*

but **it should** be understood primarily as
interaction between the two components,
from a perspective of resource recovery for sustainable development and enhancement of territories, and as initial phase of an articulated and sustained attention on one of the matrices of our historic cities

Northern Portugal regional Directorate for Culture action

The **asset recovery for each building** is the core of the action of DCRN combined with the responsible ecclesiastical institutions

This structures in the following components

typification of actions.

of asset recovery

of fostering and supporting the dissemination

data collection and characterization

collection of documentary sources and bibliographies

graphic survey and photographic and videographic records

map of uses and access scheme

risk map and pathologies mapping

immediate actions or supporting of the characterization

construction works or urgent interventions

surveys, inspections and tests

instruments of the actions of the heritage asset and cultural intervention

report of characterization, programs and prior studies

comprehensive intervention plan, technical projects

conservation plan and regular maintenance

accessibility plans and of security and emergency

The **ROUTE of CATHEDRALS in the North** project comprises seven heritage listed cathedrals located in the north of Portugal.

This set of monuments covers the entire geographical area of Northern Portugal, illustrating a network of medium-sized cities located within its territory. Such is associable to the nature of the cathedrals, while headquarters of the episcopal dignity.

The properties - listed here in chronological order of their elevation to episcopal offices and grouped by source and type – are:

of the foundation of Portugal and of medieval origin

Braga (1071), ***Porto*** (1113); ***Lamego*** (1147);

of the renaissance period and of the modern era

Miranda do Douro (1545);

contemporaneous and in adapted buildings

Vila Real (1923); ***Viana do Castelo*** (1923)

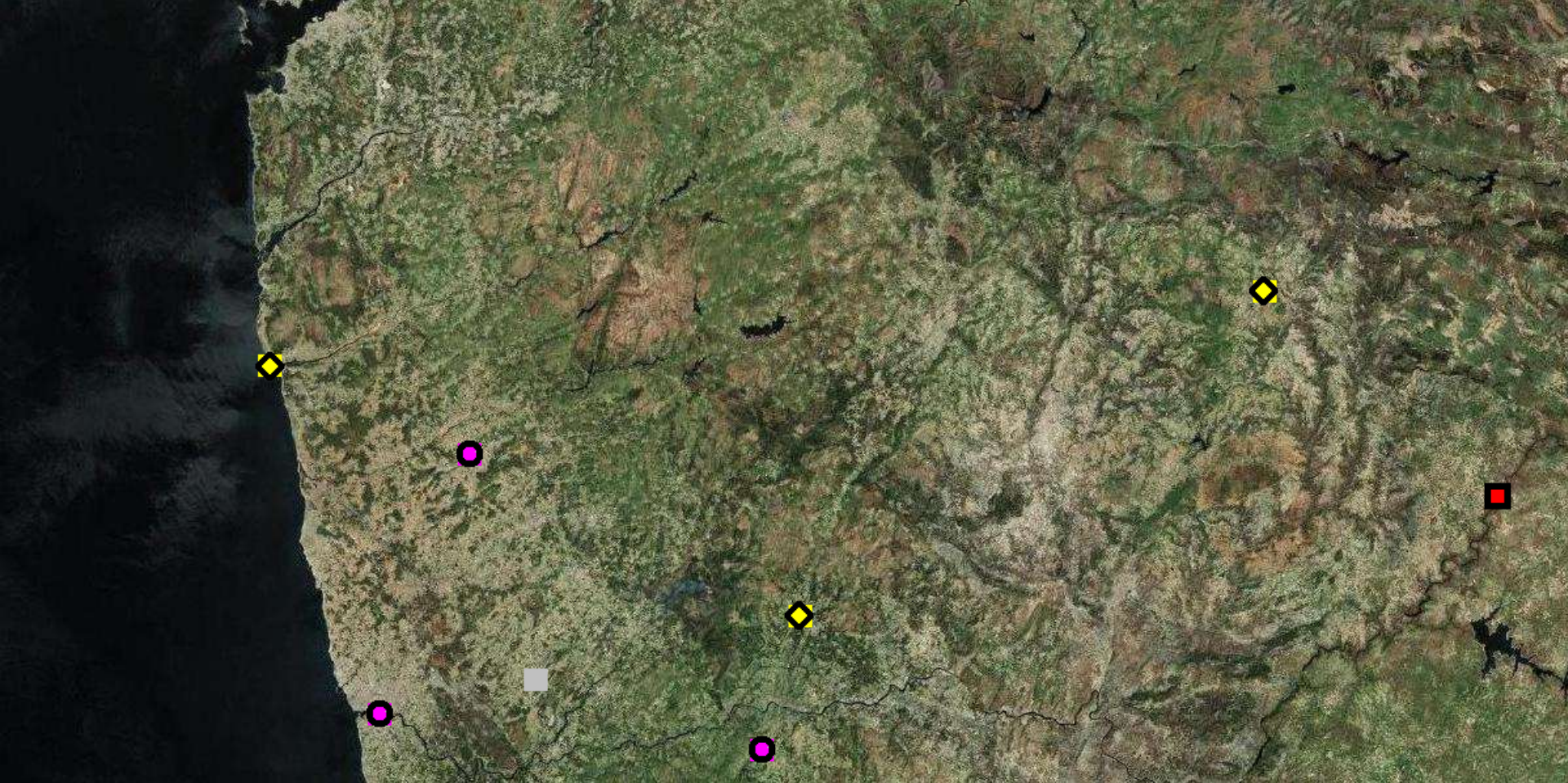

 Cathedrals of the foundation of Portugal

 of the Renaissance period

 and churches elevated to Cathedrals



BRAGA

1071



PORTO

1113



LAMEGO

1147



MIRANDA

1545 (ex1770)



BRAGANÇA

1770



VIANA

1923



VILA REAL

1923

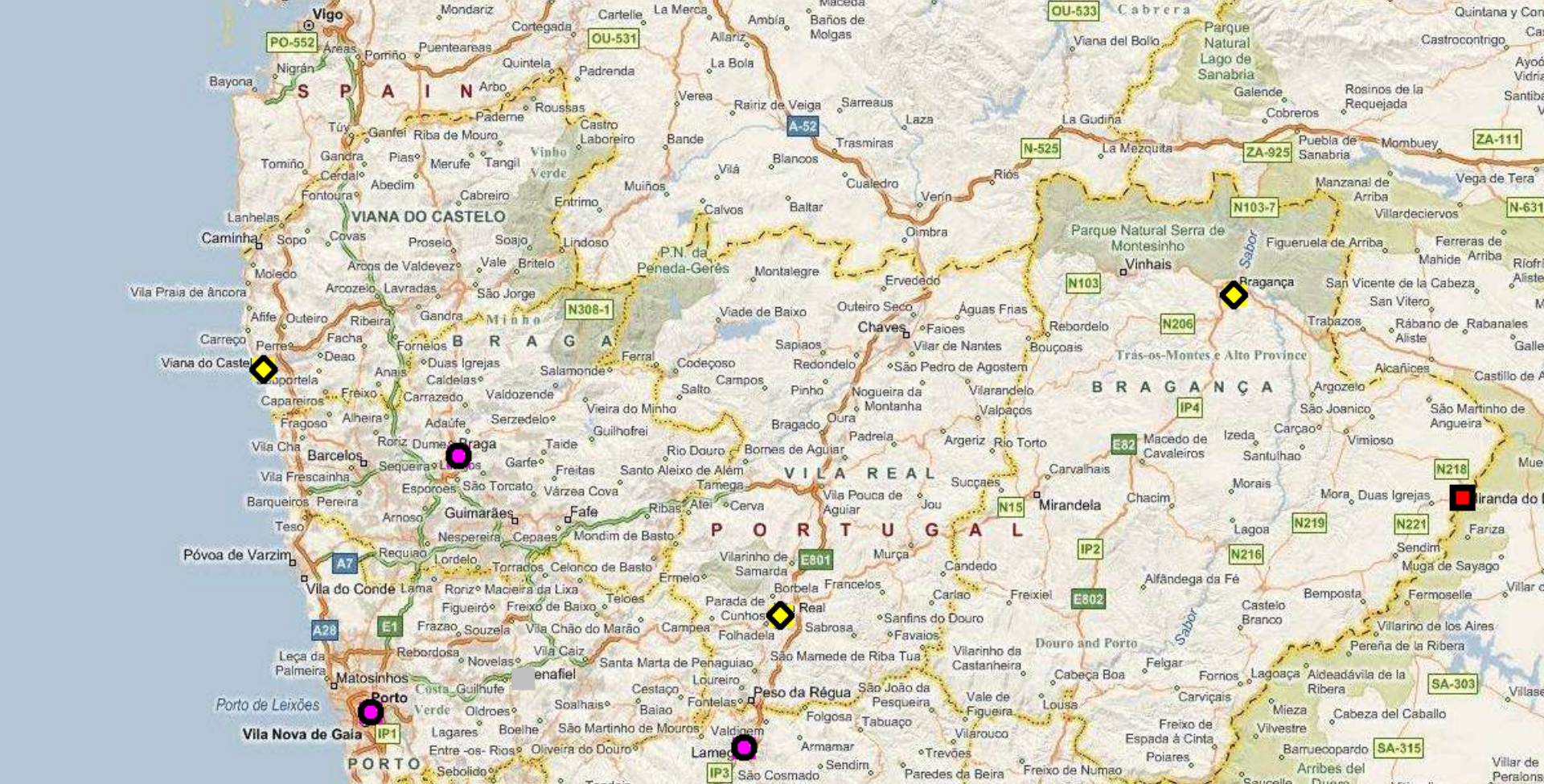

Cathedrals with cathedral program and of medieval origin

and Cathedrals adapted





set of religious architecture of the Romanesque, Manueline and Baroque periods, with isolated urban framework, inserted in the historic center.

National Monument since June 23, 1910 (state property allocated to DRCN by ordinance 829/2009 of 24 August)

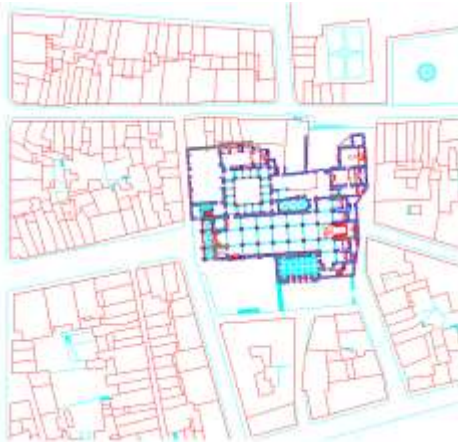

BRAGA

CATHEDRAL CHAPTER

1) Preservation and restoration of heritage integrated in the Cathedral

baptismal font and adjacent tiling

2) Preservation and restoration of integrated heritage in Chapels

altarpiece of the Souls, painted mural of Our Lady of Loreto, tiling and of the Chapel of St. Gerado

DRCN

i) review of roofing

ii) structure for “visitors’ centre”

iii) implementation of 'informative and directional signage' of the Monument and of the Route

DRCN/DSBC

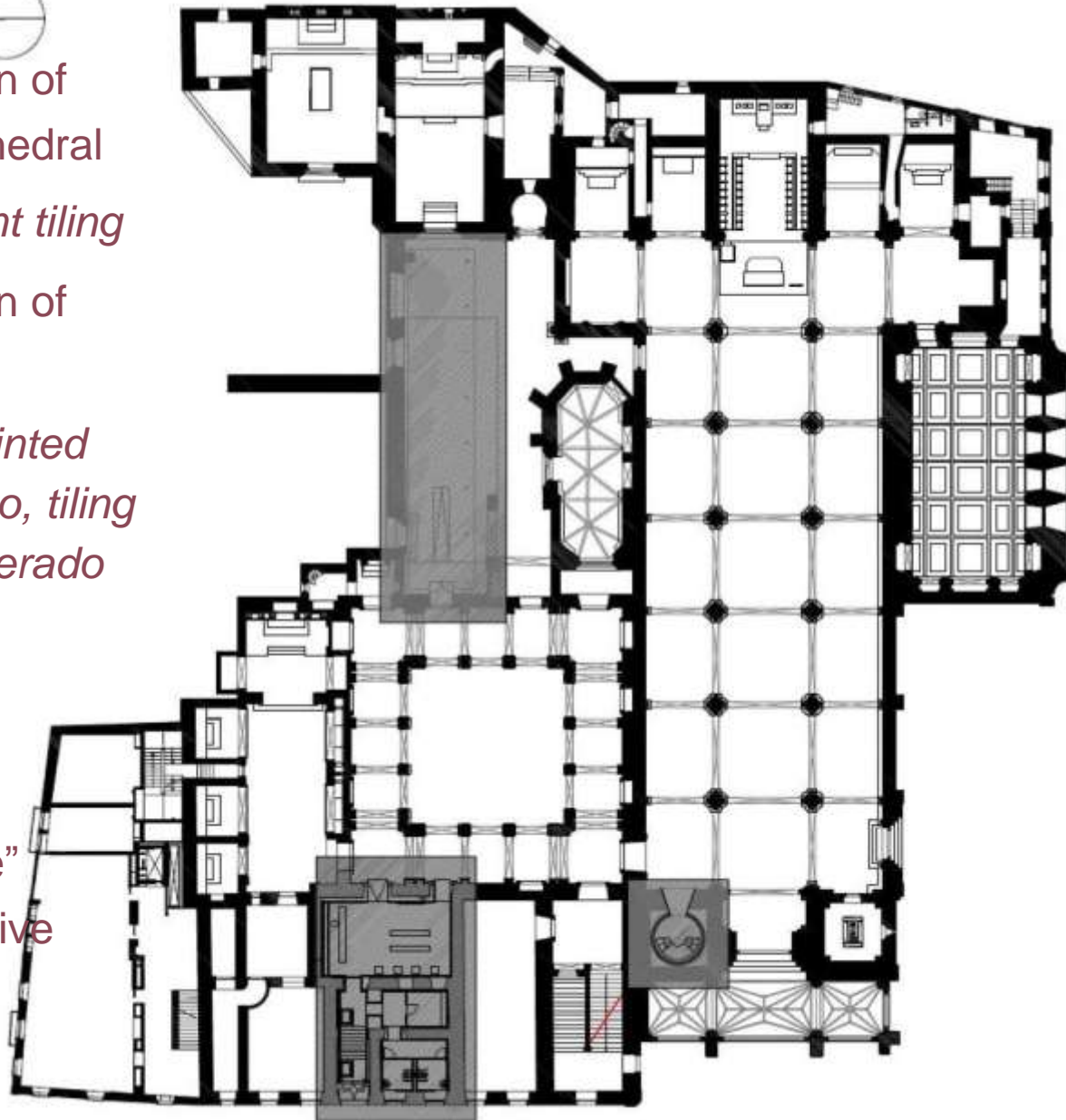



set of religious architecture of the
Romanesque, Gothic, Mannerist and Baroque
period, with isolated urban framework, inserted
in the historic center of Porto.
National Monument since June 23, 1910 (state
property without specific allocation)

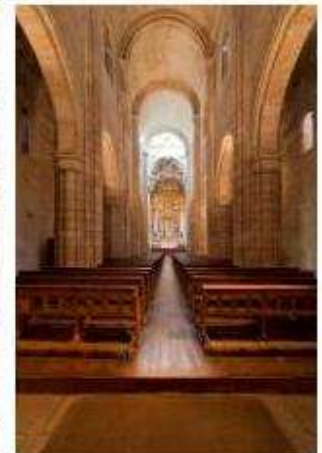
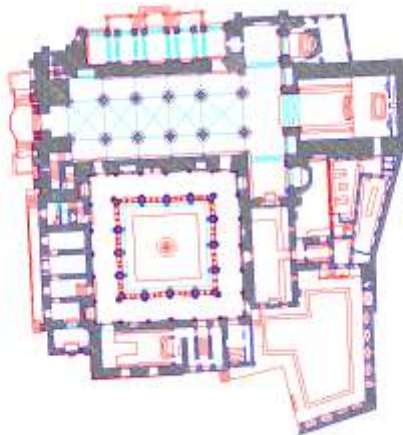

CATHEDRAL CHAPTER

- 1) Preservation and installation of the Chapter of the Cathedral of Porto with the adaptation and the release of areas to allocate to the business circuit

DRCN

- i) *ensure the preservation of the integrated heritage elements: conservation and restoration of the tile panels of the walls and of the wooden ceiling integrating pieces restored; restoration of the urn of "Holy Thursday"; restoration of the mural paintings and of stone in Gothic Sacristy*
- ii) *promote the restructuring of the Cathedral visiting circuit, reducing architectural barriers*
- iii) *ensure improved information through the implementation of 'informative and directional signage' dedicated to the Monument and based on the graphical rules defined for the Route of Cathedrals*



set of religious architecture of the
 Romanesque, Gothic, Baroque and Mannerist
 period, with isolated urban framework,
 detached noble pole of the city.
 National Monument since June 23, 1910 (state
 property without specific allocation)

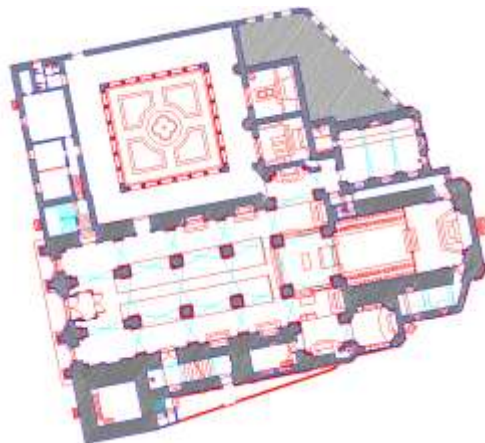

PARISH

1) Preservation and restoration of the integrated heritage in Chapels concerning the Chapel of St. Nicholas

DRCN

- i) *intervention on the facade: the stabilization of the stained glass of the window of the upper choir*
- ii) *intervention on the roofs of the chapels attached to the cloister*
- iii) *promote the qualifying of the 'access and welcoming of visitors' by revising the Chapter House areas*
- iv) *ensure improved information through the implementation of 'informative and directional signage' dedicated to the Monument and based on the graphical rules defined for the Route of Cathedrals*

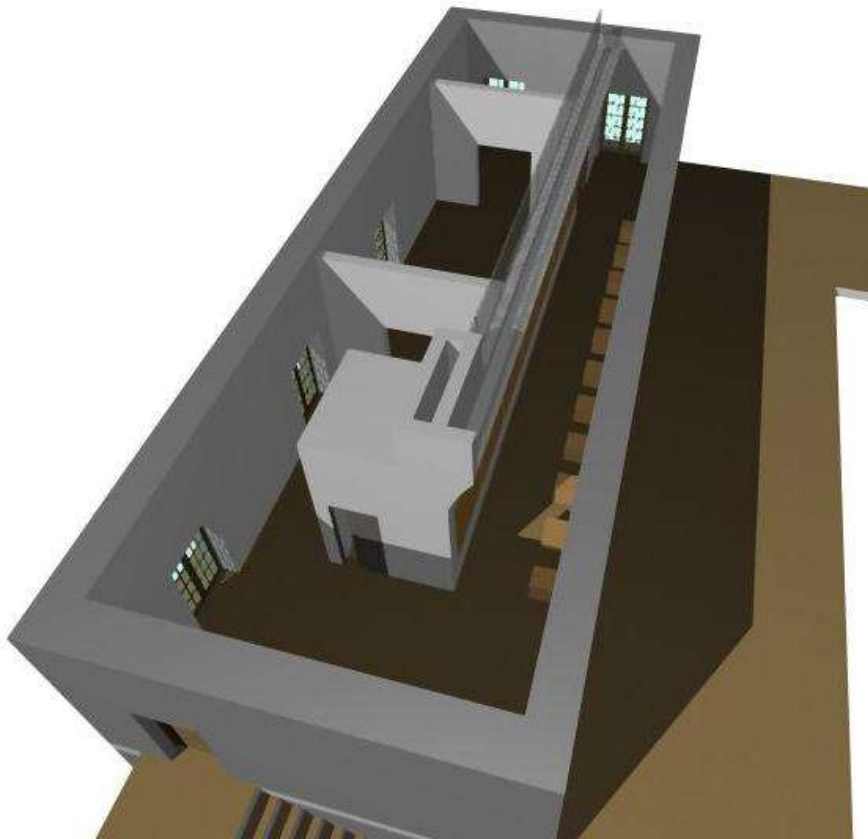



building of religious architecture of the
Mannerist period, with urban framework
isolated, spacious.

National Monument since June 23, 1910 (State
property allocated to DRCN by Ordinance
829/2009 of 24 August)

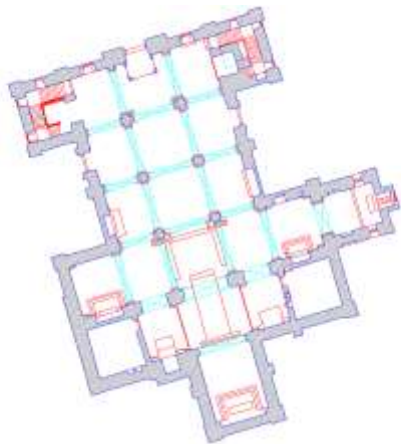

MIRANDA DO DOURO

MUNICIPALITY

1) protocolled financial support ...

DRCN

- i) *maintenance of roofing and treatment of vestments*
- ii) *preservation and restoration of the main chapel stalls, (rescue intervention of mobile assets at risk of loss)*
- iii) *promote the creation of an Interpretive Center of the City and Cathedral, in the place where stood the Bishop's Palace*
- iv) *ensure improved information through the implementation of 'informative and directional signage' dedicated to the Monument and based on the graphical rules defined for the Route of Cathedrals*

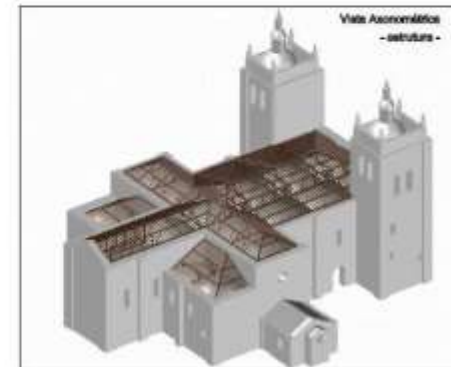
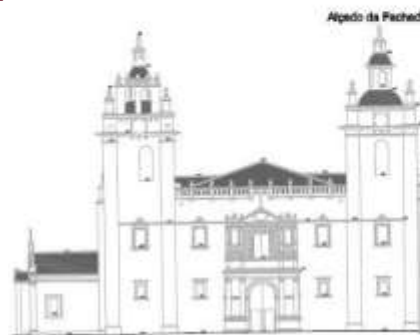
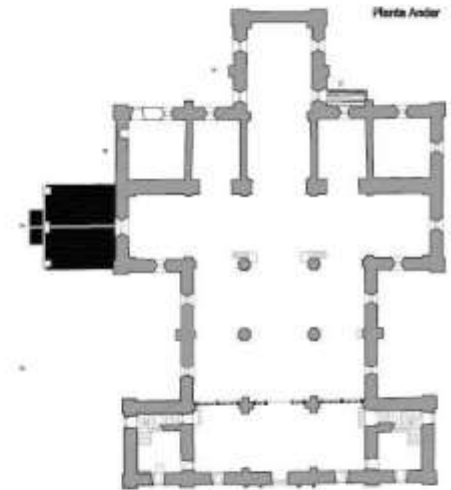
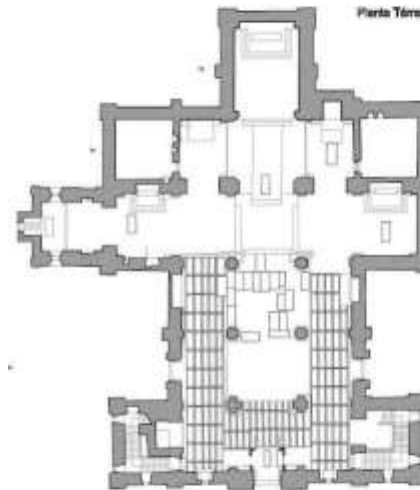
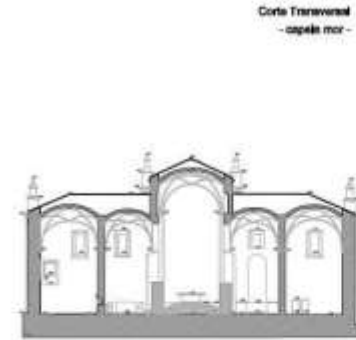



building of religious architecture of the Gothic period, integrated in the urban fabric framing. National Monument since February 19, 1926 (State property allocated to DRCN by Ordinance 829/2009 of 24 August)

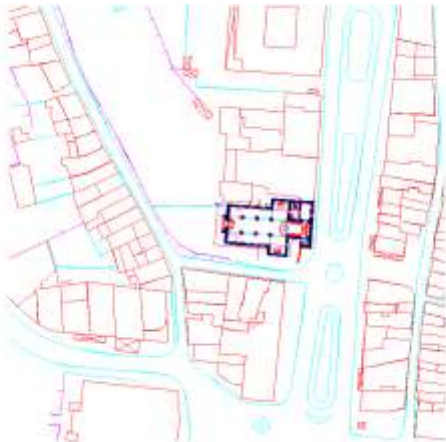
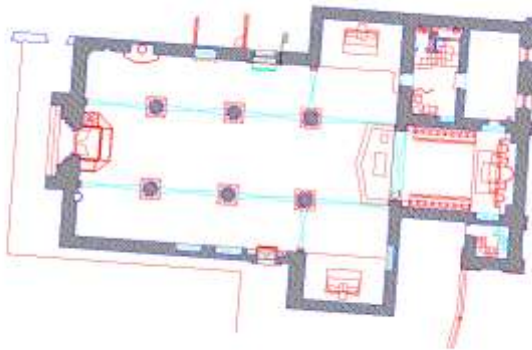

VILA REAL



PARISH

- 1) *Provision and installation of an organ in the Cathedral*

DRCN

- i) *maintenance of roofing (various repairs)*
- ii) *installation of a signaling and interpretative module for information on the Cathedral and on the Route of Cathedrals for support, host and information of visitors*



building of religious architecture of the Gothic period, integrated in the urban fabric of the historic city center (walled limit).
Public Interest Asset since April 17, 1953
(Owned by the Catholic Church)



VIANA DO CASTELO

PARISH

1) Interventions of conservation and restoration of heritage integrated in the Cathedral

altarpieces in the chapels of Our Lady of Pain and Our Lady of Artists, and the mural of the chapels of Our Lady of Pain (walls and paneled) and Our Lady of Artists (facades)

DRCN

i) *restructuring of the space of sacristy*

segregate access by cultic and cultural reasons

ii) *rehabilitation works of the towers and facade of church*

reinforcement, face the emerging risks of a structural nature

iii) *installation of a signaling and interpretative module*

for information on the Cathedral and on the Route of Cathedrals

for support, host and information of visitors

.../.

DRCN

> although this cathedral does not integrate this application, will be guaranteed the disclosure of the project, that reinforces territorial cohesion, with the ...

i) installation of a signaling and interpretative module that allows to provide

Material for the support and ongoing information on the Cathedral and on the Route of Cathedrals

support, host and information of visitors

Route of Cathedrals in Northern Portugal

BRAGA

PORTO

LAMEGO

MIRANDA DO DOURO;

VILA REAL

VIANA DO CASTELO

(BRAGANÇA)

IMMATERIAL ACTIONS OF ROUTE OF CATHEDRALS

IMMATERIAL ACTIONS OF ROUTE OF CATHEDRAL (1)

1) Music Cycle

design and production of a music cycle with repertoires for Cathedral spaces; two types of events are provided:

- i) concerts 'Route of Cathedrals': symphonic choirs*
- ii) concert 'Music in Cathedrals': groups of instrument players*

2) Exhibitions and Itinerant Installations

design and production of exhibition events; two types of events are provided:

- i) Images of the Cathedrals – photo exhibition*
- ii) Contemporary Art in the Cathedrals – with commissioner accredited*

3) Theatre Cycle

design and production of scenic events; two types of events are provided:

- i) 'monologues and rhetorical' (monologue)*
- ii) 'dialogues and imagetic' (dialogue)*

IMMATERIAL ACTIONS OF ROUTE OF CATHEDRAL (2)

4) Narratives and interpretive Speeches

design and production of interpretative and narrative content of the Route of Cathedrals, with expression in different supports:

- i) *A leaflet for each Cathedral, editing two bilingual versions (Portuguese / English and Portuguese / Spanish)*
- ii) *a brochure of the Route, bilingual (Portuguese / English)*
- iii) *a video for each Cathedral, lasting approx. 10 minutes.*
- ...

5) Management, coordination and communication of the Operation

action with instrumental nature, aimed at ensuring management tasks identified in the following activities

- i) *Communication Plan*
- ii) *Management and coordination which includes strengthening the DRCN staff*
- iii) *Instruction and monitoring of the Operation*

...

R CULTURA D NORTE



Imagem 110003
São João do Vale



Imagem 110004
São João do Vale



Imagem 110005
São João do Vale



Imagem 110006
São João do Vale



Imagem 110007
São João do Vale



Imagem 110008
São João do Vale



Imagem 110009
São João do Vale



Imagem 110010
São João do Vale



Imagem 110011
São João do Vale



Imagem 110012
São João do Vale



Imagem 110013
São João do Vale



Imagem 110014
São João do Vale



Nome: ALGUEZ
 Situação: Vila de Santa Maria da Vila



Nome: ALGUEZ
 Situação: Vila de Santa Maria da Vila



Nome: ALGUEZ
 Situação: Vila de Santa Maria da Vila



Nome: ALGUEZ
 Situação: Vila de Santa Maria da Vila



Nome: ALGUEZ
 Situação: Vila de Santa Maria da Vila



Nome: ALGUEZ
 Situação: Vila de Santa Maria da Vila



Nome: ALGUEZ
 Situação: Vila de Santa Maria da Vila



Nome: ALGUEZ
 Situação: Vila de Santa Maria da Vila



Nome: ALGUEZ
 Situação: Vila de Santa Maria da Vila



Nome: ALGUEZ
 Situação: Vila de Santa Maria da Vila



Nome: ALGUEZ
 Situação: Vila de Santa Maria da Vila



Nome: ALGUEZ
 Situação: Vila de Santa Maria da Vila