

A vertical strip on the left side of the slide shows a close-up of a stained glass window. It features intricate floral and geometric patterns in various colors, including red, blue, and gold, set within a dark stone frame.

# *Ambitious Art in Inspirational Places*

Heritage Church Tourism and the rural  
economy

Rosi Lister, Regional Director: North  
*Strategic lead for Tourism & the Arts*





# The CCT collection

345 churches no longer in regular parish use  
10% in often deprived urban communities  
20% in market towns  
70% in rural locations





## Location map of Churches Conservation Trust churches

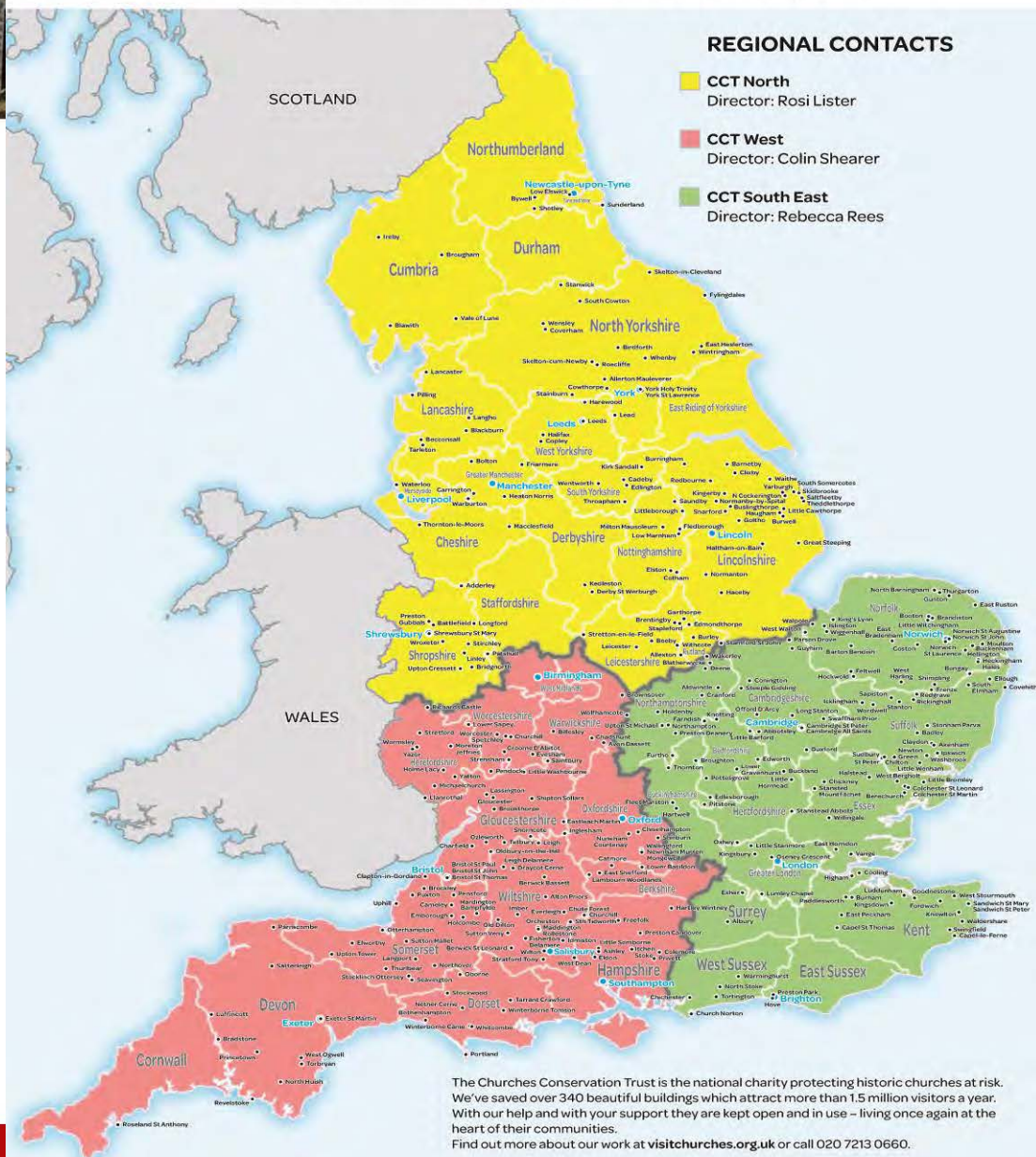

The Churches Conservation Trust is the national charity protecting historic churches at risk. We've saved over 340 beautiful buildings which attract more than 1.5 million visitors a year. With our help and with your support they are kept open and in use – living once again at the heart of their communities. Find out more about our work at [visitchurches.org.uk](http://visitchurches.org.uk) or call 020 7213 0660.



# Urban sites?

## Lend themselves to regeneration

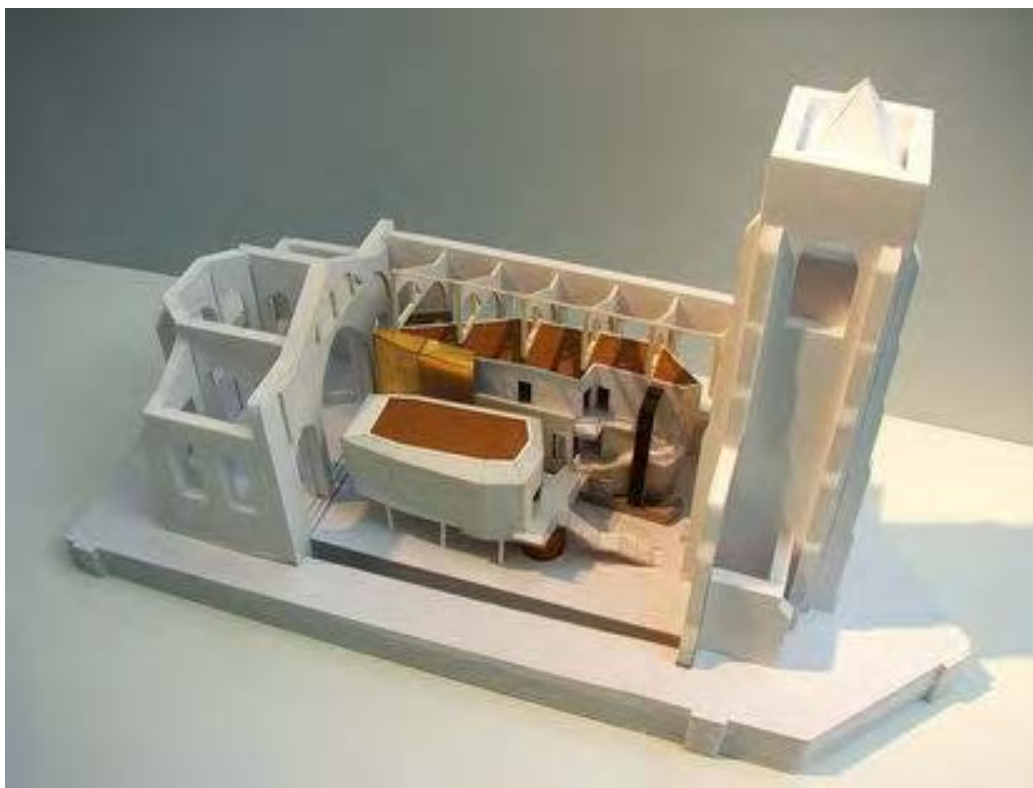



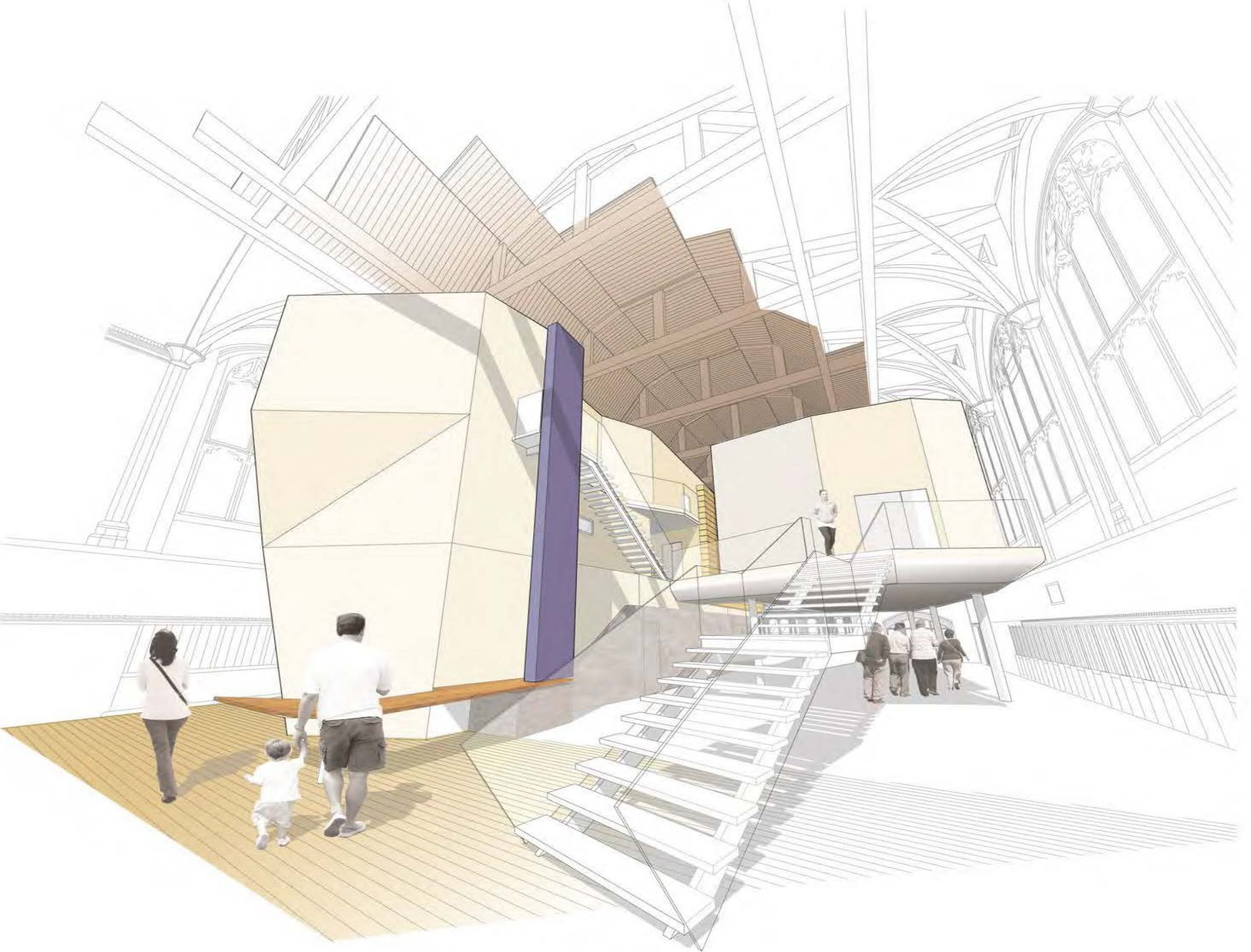

# ST MARY AT THE QUAY, IPSWICH

WELLBEING HERITAGE CENTRE

MOLYNEUX KERR ARCHITECTS

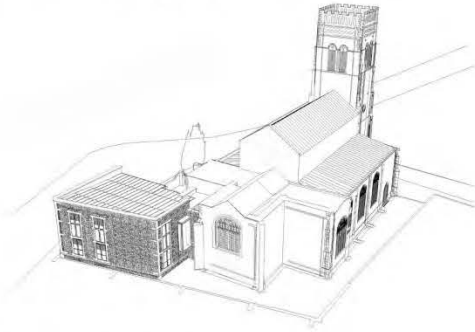

*Aerial View from the North East*

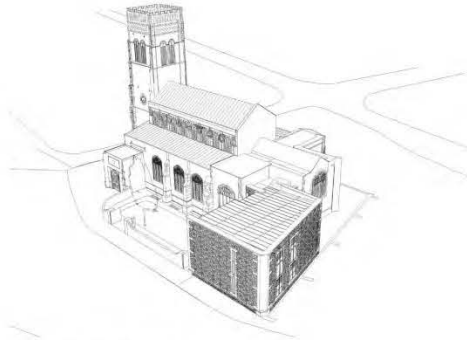

*Aerial View from the South East*

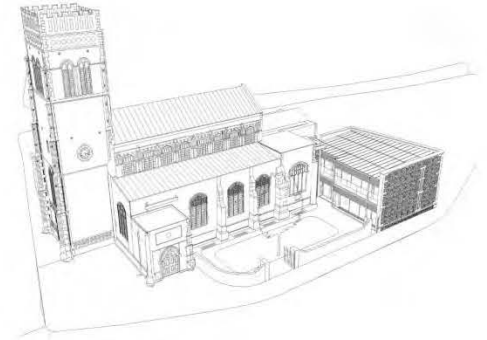

*Aerial View from the South West*



*As Proposed: View from Key Street.*

Suffolk Mind

THE CHURCHES  
CONSERVATION TRUST

heritage  
lottery fund

ENGLISH HERITAGE

"Responding to your future"





But what to do with market town churches, which traditionally were the hub of outlying rural communities...



# Conservation Churches

In 2014 CCT launched its first.

Branded, open, ‘visitor attractions’  
with a suite of interpretation,  
managed by volunteers, with  
upgraded facilities, and actively  
engaging new audiences through  
tailored tourism packages











...of words, banderoles. The rest of the  
St Bernard collection can be found in the south aisle.



A vision  
of angels



A healing  
touch

The start of  
a vocation



Prayer for  
strength



Convincing  
a king







Emergency exit





## The Jesse Window

St Mary's was not the first home for one of the finest Jesse windows in the country.

The window was installed here in 1766, after the collapse of St Chad's church nearby. It was probably made originally for the local chapel of Greyfriars, but was removed during the Dissolution of the Monasteries, between 1536 and 1541, during the reign of Henry VIII.







I WAS ONCE  
A FEARLESS KNIGHT  
BUT MY WEARY BONES  
NOW LAY AT REST.

THROUGHOUT THE AGES  
I HAVE BEEN REMEMBERED  
IN MANY PLACES IN THIS  
HOUSE OF GOD.

WHERE WOULD YOU  
HAVE ME LIE?











# St Mary's Shrewsbury

- 60,000 visitors a year
- Now the most visited site in the town
- Features in the rural county of Shropshire's Tourism Plan
- Café employing local people
- Volunteers learning valuable new skills



Conservation Churches are designed to be Gateway's to our rural churches.

In the countryside we need to help visitors to plan their visit and provide extra incentives to seek these beautiful buildings out...





















der at  
asures



THE CHURCHES  
CONSERVATION TRUST

gaze at  
divine  
riches

Historic churches in  
Bedfordshire  
Essex  
Greater London  
Hertfordshire







All Saints  
Haugham



London Road A16





## "Why not make a virtuous visit to one of our historic churches followed by a wickedly good lunch!"

Saints & Sinners covers four distinctive areas of Lincolnshire - Wolds, Coast, Marshes & Countryside - linking historic churches with fabulous places to enjoy the wickedly good flavour of Lincolnshire.

Information about art trails, cycle routes & events which are all part of the ArChWay Project can be found by visiting our website all designed to make your visit a fun adventure!

To find out more please see:  
[www.visitchurches.org.uk/archway](http://www.visitchurches.org.uk/archway)  
 T: 0113 244 1689 E: [archwayproject@tctc.org.uk](mailto:archwayproject@tctc.org.uk)

The ArChWay (Arts in Churches) project is jointly funded for three years by The Churches Conservation Trust and the Rural Development Programme for England (RDPE) via the Lincolnshire LEADER Action Groups - the Coastal Action Zone and the Lindsey Action Zone.



### Haugham, All Saints

The spire of All Saints soars above the surrounding trees in the open country of the Wolds, visible for miles around. As you reach All Saints on foot down a green lane, you might expect a rustic church - in fact, the building is an example of ecclesiastical elegance. It was built in 1840, modelled on the church of St James in nearby Louth. Inside, the church is solid and welcoming. There are handsome pews, beautiful stained glass windows and memorials to local Lincolnshire families.

Haugham, Louth LN11 8PU  
 → 4m S of Louth and W of A16  
 Open daily

### Little Cawthorpe, St Helen's

This charming Victorian church - with its colourful red brick, vibrant stained glass and elegant spire - was built in the style of 14th-century Gothic architecture. It was lauded as a perfect example of a modest parish church.

Watery Lane, Little Cawthorpe, Louth LN11 8LZ  
 → 3m SE of Louth off A157  
 Open daily

### The Sebastopol Inn

A quintessentially English village pub that started life as an unnamed ale house in 1836. The Sebastopol Inn offers a warm welcome and excellent food, using locally sourced ingredients to create both traditional and contemporary dishes. A children's menu is available to cater for little mouths. Cask ales and extensive wine list. Open for lunch and dinner Tuesday to Saturday and for Sunday lunch. Closed Monday (except bank holidays)



Tel 01507 578577  
 for reservations or email  
[thesebastopol@hotmail.co.uk](mailto:thesebastopol@hotmail.co.uk)  
[www.thesebastopol.com](http://www.thesebastopol.com)  
 Church Lane | Minting | Horncastle  
 Lincolnshire | LN9 5RS

### The Red Lion

A pretty little pub in a picturesque village setting that provides both excellent food & accommodation. Family run and offering a fine range of traditional dishes using quality local ingredients. The Red Lion restaurant has won a number of awards for their traditional taste of Lincolnshire. Closed Tuesday low season please call to avoid disappointment



Tel 01790 752271  
[enquiries@redlioninnpartney.co.uk](mailto:enquiries@redlioninnpartney.co.uk)  
[www.redlioninnpartney.co.uk](http://www.redlioninnpartney.co.uk)  
 The Red Lion | Skegness Road | Partney  
 Nr Spilsby | Lincolnshire | PE23 4PG

### Kenwick Nursery & Tea Rooms

Situated on the edge of the Lincolnshire Wolds near Louth in an area of outstanding natural beauty. The Kenwick Nursery Tea Rooms offer a delightful place to stop and enjoy quality food sourced locally. The Tea room offers an extensive gluten free option for coeliac customers. The perfect place for a family Sunday lunch or a warming snack



Open Tuesday - Sunday and Bank  
 Holiday Mondays 10.00am - 4.00pm  
 Tel 01507 606469  
[www.kenwicknursery.co.uk](http://www.kenwicknursery.co.uk)  
 Kenwick Farmhouse Nursery | Kenwick  
 Road | Louth | Lincolnshire | LN11 8NW





However, perhaps even more importantly we need to 'Reveal' our churches to new audiences – to broaden understanding that this is such important heritage

By offering our churches to Artists as both venue and subject material we begin to write a new narrative for these historic buildings as 'relevant' cultural spaces...





Back cover Gormley exhibition, St Mary, Shrewsbury





















LN11 8PF  
LN11 0QD  
DN36 5PF  
LN8 5JD

There is a quiet here.  
As you steer carefully  
down the causeway,  
a drop on either side,  
it hides behind the trees,  
the gate and hundreds of  
years. There is a quiet here.  
The tower leans gently  
to the west,  
the rest of the building  
just sits.  
You know that it's been  
waiting for you.  
That weathered chest  
above the door  
is more than just a  
decoration. With some  
hesitation, you walk the  
path and step inside.  
It feels as if something is  
drawing near.  
Not quite a thing that you  
can name, but just -  
there is a quiet here.







The rabbits dig up human bones  
and undermine the church.  
It perches on the hilltop like a crow.  
A tow of angels gather on the ceiling  
kneading upside down in silent prayer.  
They stare at the sleeping floor,  
hoping more than anything  
that this place stays up.  
At the top of the slope,  
with his back to the sun,  
St. Michael looks on and waits  
for heaven to be restored  
by the fire of his sword  
and the strength of these stones.  
And, in the unexplored warrens below,  
the rabbits dig up human bones.



LN11 0QD  
DN36 5PR  
LN11 7TU  
LN8 5JD



The image shows the interior of a church. A large, light-colored mural with a faint, ghostly figure is on the wall. Above the mural is a wooden archway. Below the mural is a white arched opening. Through the archway, a wooden altar with a cross on top is visible. The altar is surrounded by a white railing. The walls are light-colored and show some cracking. The ceiling is made of dark wooden beams.

It feels as if something is drawing near.













## 2010 - 2013 The Rural Development Programme for England funded the **ArCh:Way Project** (Art in Churches)

- 14 historic churches in rural Lincolnshire
- Increased visitors to the area by 20,000
- Generating an additional £300,000 worth of local economic activity



## **New Arts Strategy: “Ambitious Art in Inspirational Places”**

- National Arts Advisory Panel
- Contemporary Art programme
- Mentoring for ‘emerging’ artists
- Partnership with the Arts Council of England





## An opportunity to join up:

- The Arts Council need rural ‘venues’ to increase arts participation
- The CCT need new reasons for people to visit rural churches















# We are looking for partners...

Email [rlister@thecct.org.uk](mailto:rlister@thecct.org.uk)



